

### STAINLESS STEEL CONSTANT FORCE SPRING BAND OPTION

SPRING BANDS ARE RE-USABLE AND SELF TENSIONING TO SECURE BOTH OVERALL AND INDIVIDUAL BRAID TERMINATIONS. THE SPRING IS EASY TO INSTALL AND REQUIRES NO TOOLING WHILE PROVIDING A HIGH LEVEL OF TENSILE STRENGTH TO THE ASSEMBLY. THE CONSTANT FORCE SPRINGS ARE SUITABLE FOR CORROSIVE ENVIRONMENTS AND ARE NOT AFFECTED BY VIBRATION, SHOCK OR EXTREME TEMPERATURES.

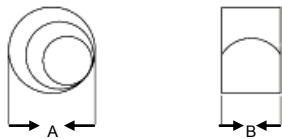

TABLE I - STAINLESS STEEL SPRING BAND					
SPRING BAND P/N	CABLE ENTRY SIZE (SECTION B)	MIN / MAX ENTRY DIAMETER	AMAX	B +/- 0.2	URNS +/- 0.25
SB5	01	.125 MAX	.295 (7.5)	.374 (9.5)	
SB10	31, 02, 32, 03, 33	.188 / .438	.315 (8.0)	.374 (9.5) 4.5	
SB20	04, 34, 05, 35	.500 / .688	.504 (12.8)	.374 (9.5)	3
SB30	06, 36, 07, 37, 08	.750 / 1.000	.705 (17.9)	.374 (9.5)	4.25
SB40	38, 09, 10, 11, 12	1.062 / 1.500	.858 (21.8)	.374 (9.5)	3.5

### STAINLESS STEEL TERMINATION BAND OPTION

THE TF600 SERIES TERMINATION BANDS ARE PRECISION CONSTRUCTED OF 300 SERIES SST/PASSIVATE AND DE-SIGNED FOR USE WITH STANDARD HAND BANDING TOOLS OR PNEUMATIC BANDING TOOLS. BANDS MAY BE ORDERED FLAT OR PRE-COILED AND IN STANDARD AND MICRO SIZES.

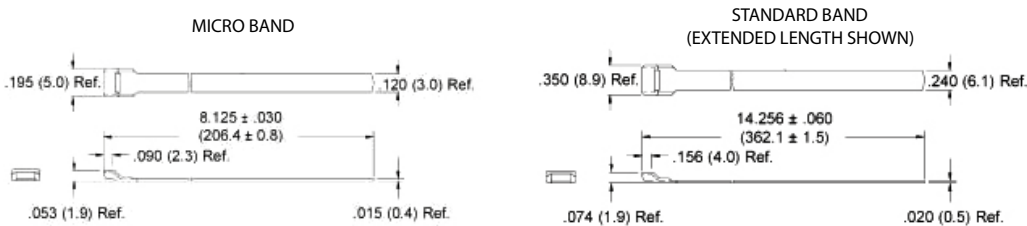

TABLE II - STAINLESS STEEL TERMINATION BAND			
ORDERING CODE	TERMINATION BAND P/N	DESCRIPTION	STEEL
B	TF610-052	STANDARD	SERIES 304
B1	TF610-052-A	PRE-COILED STANDARD	SERIES 304
M	TF610-057	MICRO	SERIES 304
M1	TF610-057-A	PRE-COILED MICRO	SERIES 304
X	TF610-083	EXTENDED LENGTH	SERIES 304
X1	TF610-083-A	PRE-COILED EXTENDED LENGTH	SERIES 304